

Power Inductor

GSLRH124T-0R5N

Page : 1/2

- Family of High Current Power Inductors
- L: 0.5 +/- 30% uH
- DCR: 3.0 m ohm Max
- IDC: 14 A Max

Electrical Parameters

No	L (μ H)	D.C.R (Max) m Ω	IDC (Max) A		
Frequenc y	100KHz/ 0.5V		100kHz/0.5V		
Tester	VR126 LCR	502 BC	VR126+VR7220		
Spec	0.5 \pm 30%	3.0	L _{0A}	L _{14A}	\leq 10%
1	0.45	2.37	0.45	0.43	4.44%
2	0.44	2.39	0.44	0.42	4.55%
3	0.47	2.37	0.47	0.46	2.13%
4	0.46	2.38	0.46	0.45	2.17%
5	0.48	2.38	0.48	0.47	2.08%
MAX	0.48	2.39	0.48	0.47	2.08%
MIN	0.44	2.37	0.44	0.42	4.55%
AVE	0.46	2.38	0.46	0.45	3.04%

Dimension Testing (Unit: mm)

No	A	B	C	D	E
Spec	12.3MAX	12.3 MAX	4.5 MAX	5.0 \pm 0.2	8.0 \pm 0.2
1	12.17	12.10	4.22	5.01	8.01
2	12.21	12.14	4.20	5.00	7.98
3	12.19	12.12	4.28	5.02	7.99
4	12.17	12.15	4.21	4.99	8.02
5	12.19	12.18	4.24	4.98	8.01
MAX	12.21	12.18	4.28	5.02	8.02
MIN	12.17	12.10	4.20	4.98	7.98
AVE	12.19	12.14	4.23	5.00	8.00

Power Inductor

GSLRH124T-0R5N

Page : 2/2

SCHEMATIC



MECHANICAL

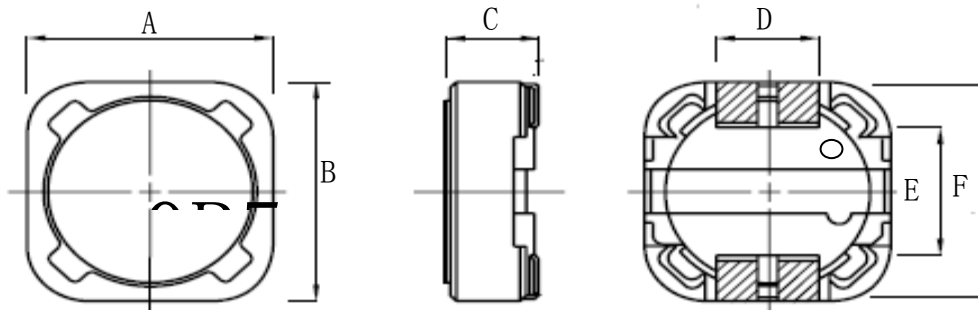

- A: 12.30 mm MAX
- B: 12.30 mm MAX
- C: 4.5 mm MAX
- D: 5.0 ± 0.2 mm
- E: 8.0 ± 0.2 mm
- F: 11.6 mm REF