

CONNECTOR LAYOUT

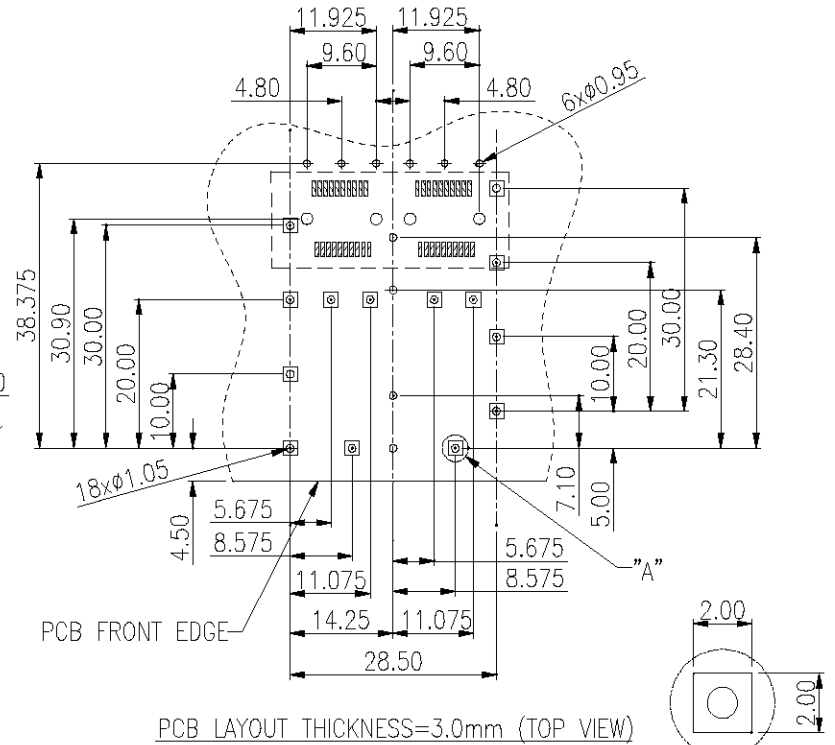

PCB LAYOUT THICKNESS=3.0mm (TOP VIEW)

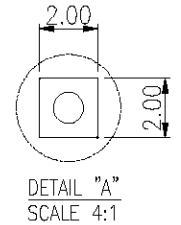

DETAIL "A"
SCALE 4:1

REVISION RECORD				
REV	ECO	DESCRIPTION	DRFT	CHKD

NOTE:

- DESCRIPTION MATERIAL PLATING
01 SFP TOP CAGE COPPER ALLOY NICKEL PLATING
02 SFP BOTTOM CAGE COPPER ALLOY NICKEL PLATING
- TEMPERATURE:
OPERATION: -40°C~ +85°C
STORAGE: -40°C~ +85°C
- RoHS COMPLIANT
- PART NUMBER : SFP012-L

MM (INCH)		DFTD ANY	DATE 08/16/09	Xmultiple Technologies, Inc.	
TOLERANCES EXCEPT AS NOTED		CHKD	DATE	TITLE	
		MFD	DATE		
MM	±	APPL	DATE	SFP CAGE 1x2 PORT	
.0 ±0.20	±				
.00 ±0.15	±			DRAWING NO. SFP-012	
.000 ±0.075	±			/PART NO. SEE NOTE	
ANGLES ±		MATERIAL :		SIZE	REV
		QTY :		A3	0
THIRD ANGLE PROJECTION		FINISH :		DO NOT SCALE DRAWING	
		SCALE :		SHEET X OF Y	

8

7

6

5

4

3

2

1

H
G
F
E
D
C
B
A